

Important information

"Subject to the terms and conditions of this Limited Warranty and in lieu of any other (if any) express warranties, Luidia warrants that under normal use and service, for twenty four (24) months from delivery to a LCD bracket end user, the LCD bracket, if used as authorized in accordance with the LCD bracket packaging and documentation, will not have significant defects in materials or workmanship that make the LCD bracket unusable. As to any defects discovered after the Warranty Period, there is no warranty or condition of any kind. Luidia makes no warranty or representation that the LCD bracket will meet any end user's specific requirements, that the operation of the LCD bracket will be secure, uninterrupted or error free, or that all defects in the LCD bracket will be corrected. Luidia makes no warranty, implied or otherwise, regarding the performance or reliability of any third party product (hardware or software). Installation of the LCD bracket on any third party products other than as authorized by Luidia herein will void all warranties given by Luidia. In addition, use, modification and/or repair of the LCD bracket other than as authorized by Luidia voids all warranties.

TO THE MAXIMUM EXTENT PERMITTED BY APPLICABLE LAW, EXCEPT FOR THE EXPRESS LIMITED WARRANTIES SET FORTH ABOVE, NEITHER LUIDIA NOR ITS SUPPLIERS MAKE ANY REPRESENTATIONS OR WARRANTIES TO ANY PERSON OR ENTITY WITH RESPECT TO THE LCD BRACKET, WHETHER EXPRESS, IMPLIED, STATUTORY, OR IN ANY OTHER PROVISION OF THIS NOTICE OR ANY OTHER COMMUNICATION, AND LUIDIA AND ITS SUPPLIERS SPECIFICALLY DISCLAIM ANY IMPLIED WARRANTY OR CONDITION OF SECURITY, MERCHANTABILITY, FITNESS FOR A PARTICULAR PURPOSE, TITLE AND/OR NONINFRINGEMENT OF THIRD PARTY RIGHTS. THERE IS NO WARRANTY OR REPRESENTATION THAT THE OPERATION OF THE LCD BRACKET WILL BE UNINTERRUPTED, FAULT-TOLERANT, SECURE OR ERROR-FREE. TO THE MAXIMUM EXTENT PERMITTED BY APPLICABLE LAW, THE SOLE LIABILITY OF LUIDIA, AND THE SOLE REMEDY, RELATING TO ANY AND ALL APPLICABLE WARRANTIES SHALL BE, AT LUIDIA'S OPTION, TO REPAIR THE LCD BRACKET, REPLACE THE LCD BRACKET, OR PROVIDE A REFUND FOR THE PRICE PAID TO LUIDIA FOR THE LCD BRACKET."



www.e-beam.com | 1.888.99.eBeam

Luidia Inc. is the creator of eBeam® interactive technology that helps the world capture and share content. The company's products are utilized by organizations of all sizes, with hundreds of thousands of users across multiple industries and geographies. For more information on Luidia, please visit www.e-beam.com or follow on Twitter and Facebook @eBeam.

©2016 Luidia, Inc. All rights reserved. eBeam and the Luidia logo are registered trademarks of Luidia, Inc. Other product names and logos are the property of their respective owners.

Empowering you to interact, share, create, learn and educate in your interconnected world.

Connect with Us

 twitter.com/eBeam

 [search for eBeam](https://www.facebook.com/eBeam)

 [youtube.com/LuidiaTech](https://www.youtube.com/LuidiaTech)

Recommended Display Specifications

Resolution: 1080p (1920 x 1080 px)

Illumination: LED backlit LCD !

Size: 40" to 80"

Bezel Depth: <1/4" (6.35mm)

eBeam Edge+ has been tested on many different TVs in different situations, and the Edge+ delivers the same great performance on a display as it does with a projector. Due to differences in TV construction, performance can vary slightly from display to display, but most modern displays are fully compatible with eBeam.

! It is important that the display is LED backlit to keep the temperature of the display surface close to room temperature. Plasma TVs and older LCD TVs are not ideal for use with eBeam Edge+.



Getting started

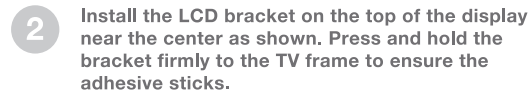
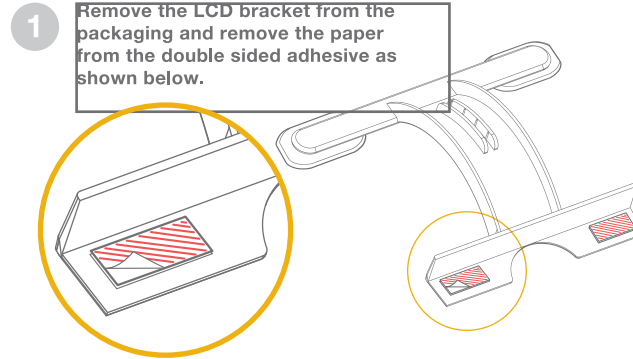

(It can be removed from the display by slowly and carefully pulling forward on the bracket, gradually releasing the grip of the adhesive..)

